

Entrance Control System 2021 Ansi-Z

STANDARD EQUIPMENT LIST:

- 1) FOUR DOOR VESTIBULE REPRESENTS ADA/ANSI INTERPETATION
- 2) HEAVY GAUGE STAINLESS STEEL FRAME AND DOORS
- 3) CEIA WEAPONS DETECTOR 02PN8
- 4) SYSTEM TOUCH SCREEN CONTROL UNIT
- 5) SECURITRON MAGLOCK M62B ON ALL DOORS
- 6) REQUEST TO EXIT PUSH BARS ON DOOR 1 AND 4
(DOOR 1 & 4 PUSH BARS OVERRIDE MANUAL LOCKS)
- 7) AUDIO IS 5501-2 WITH 5004 MINI MATRIX
- 8) KEYLOCK EXTERIOR AND THUMB KNOBS INTERIOR ON DOOR 1 AND 4
- 9) ONE WIRELESS ADMIT SWITCH STANDARD
- 10) CEILING 3/4" THICK WHITE MELAMINE
- 11) L.E.D. LIGHT PACKAGE
- 12) SHUNT SWITCH WITH ADA CALL BUTTON ON CENTER POST
- 13) LOCKABLE SERVICE HATCH



IMPORTANT NOTE

Code Compliance is the Responsibility of the End User Drawing Represents Hamilton's Interpretation Only All Drawing Must Be Approved By Local Municipality

DESCRIPTION

Stainless Steel Entrance Control System Significant Changes to ICC A117.1-2017 Accessibility Standard - 2021 Edition Overall Dimensions and Import Notes

DRAWING/MODEL NUMBER
18-097

DATE
1/24/2022

PAGE

1 5

est. 1967

HAMILTON
CUSTOM MADE SECURITY

PROPRIETARY AND CONFIDENTIAL
THESE DRAWINGS ARE THE PROPERTY
OF HAMILTON SAFE CO. AND SHALL
NOT BE REPRODUCED, COPIED, USED
AS THE BASIS FOR MANUFACTURE OR
SALE OF APPARATUS WITHOUT
PERMISSION

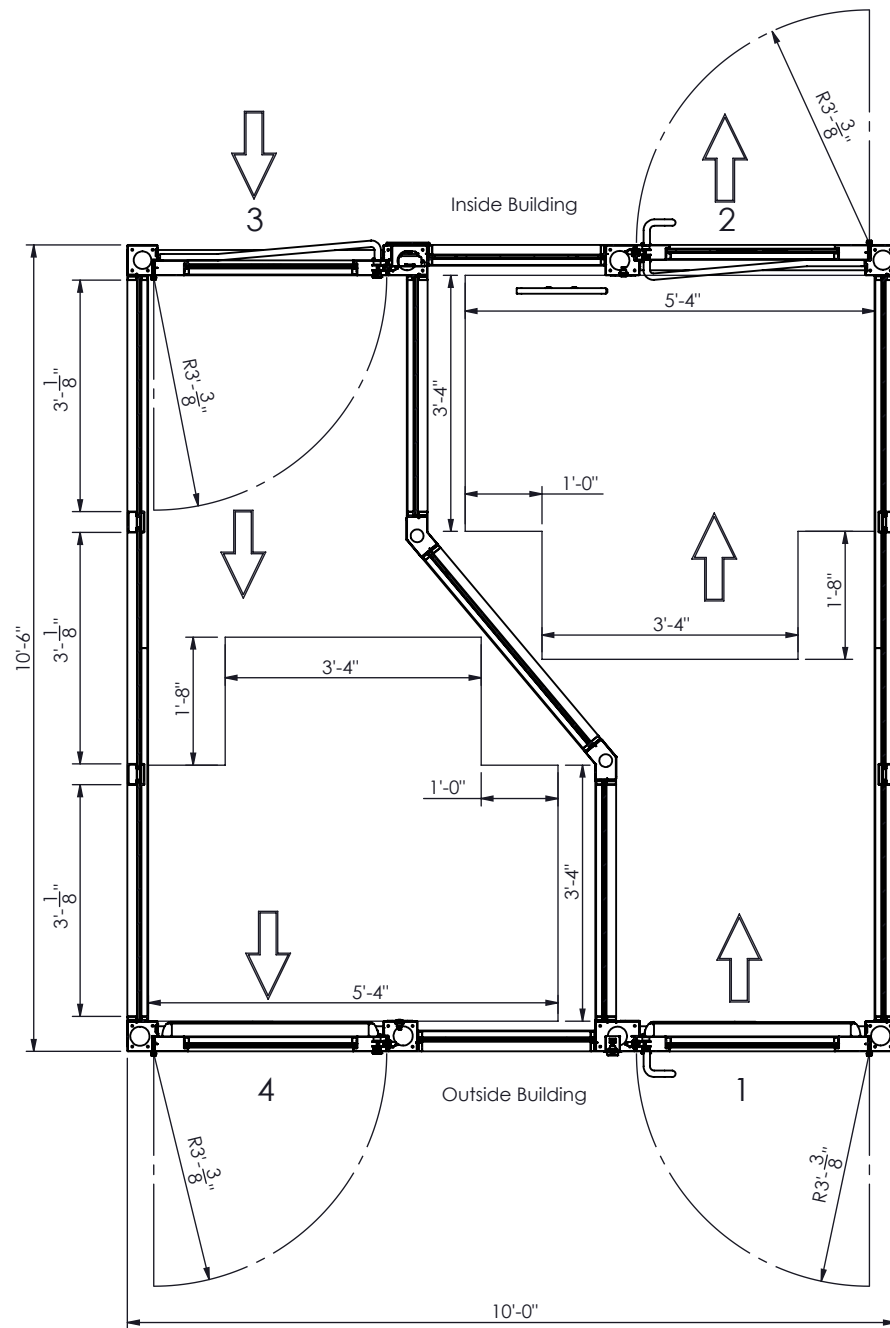

SECTION 201
(ICC/ANSI A117.1-2017)

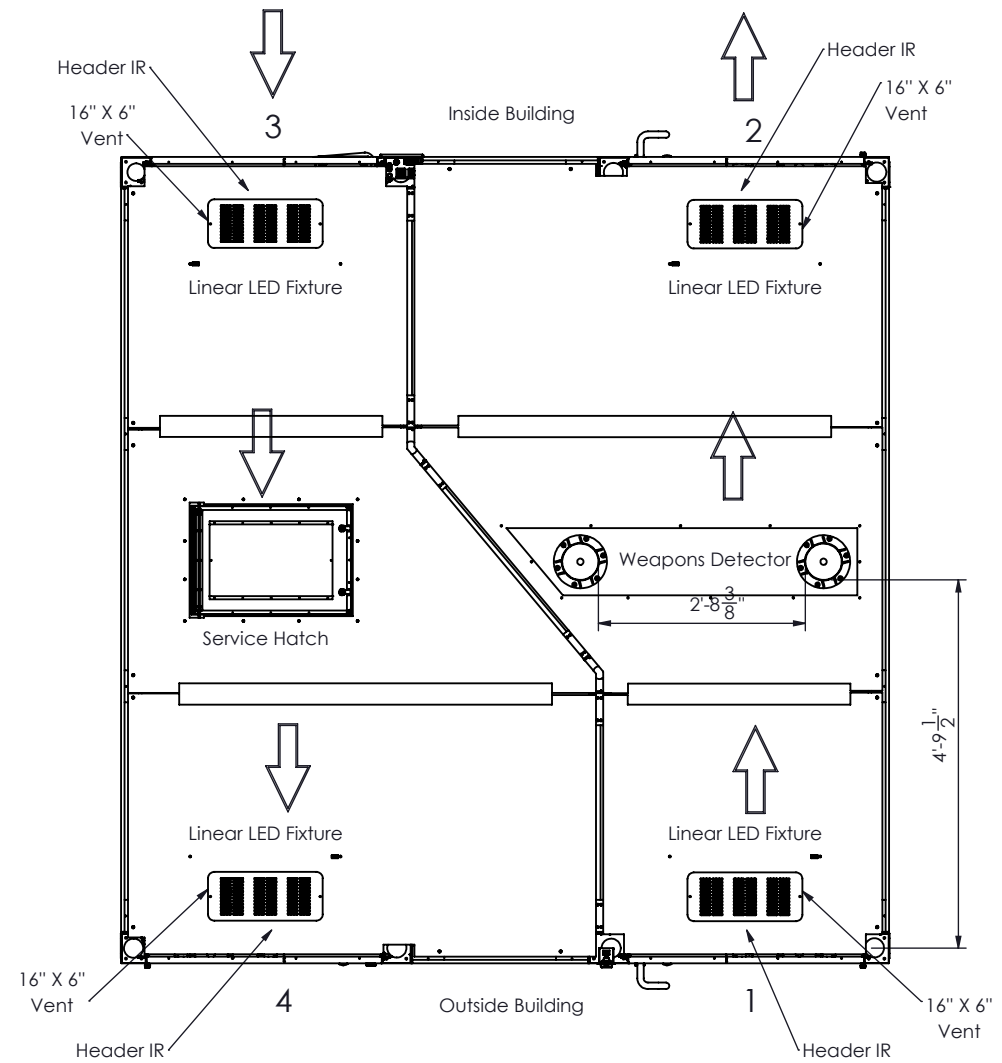

SECTION 202
PLAN VIEW

IMPORTANT NOTE

Code Compliance is the Responsibility of the End User Drawing
Represents Hamilton's Interpretation Only All Drawing Must Be
Approved By Local Municipality

DESCRIPTION

Stainless Steel Entrance Control System Significant Changes to
ICC A117.1-2017 Accessibility Standard - 2021 Edition Overall
Dimensions and Import Notes

DRAWING/MODEL NUMBER
18-097

DATE
1/24/2022

PAGE

2

5

est. 1967
HAMILTON
CUSTOM MADE SECURITY

PROPRIETARY AND CONFIDENTIAL
THESE DRAWINGS ARE THE PROPERTY
OF HAMILTON SAFE CO. AND SHALL
NOT BE REPRODUCED, COPIED, USED
AS THE BASIS FOR MANUFACTURE OR
SALE OF APPARATUS WITHOUT
PERMISSION

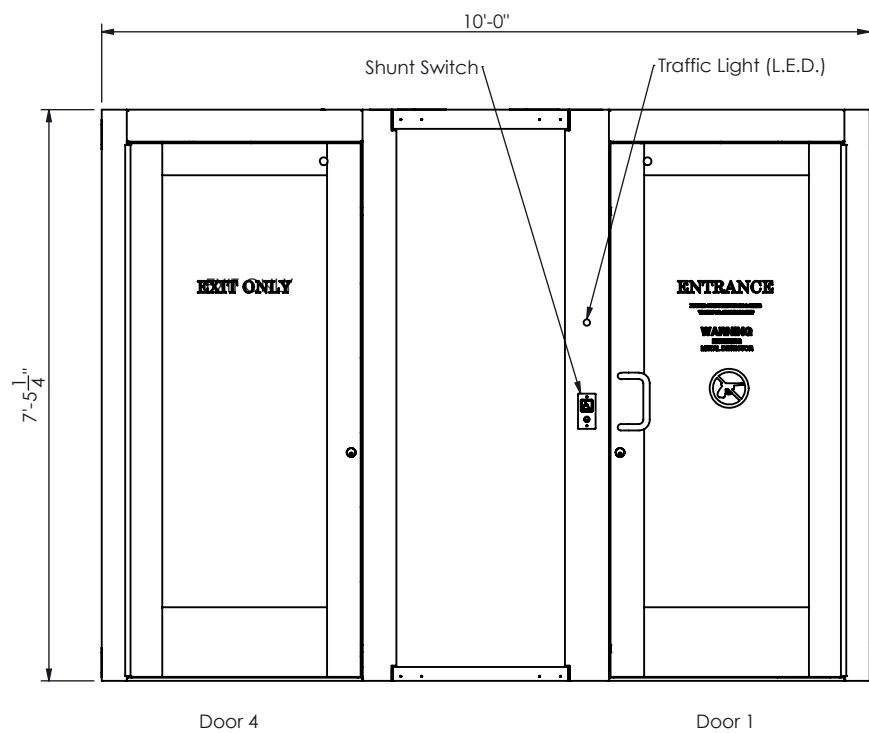

FRONT ELEVATION

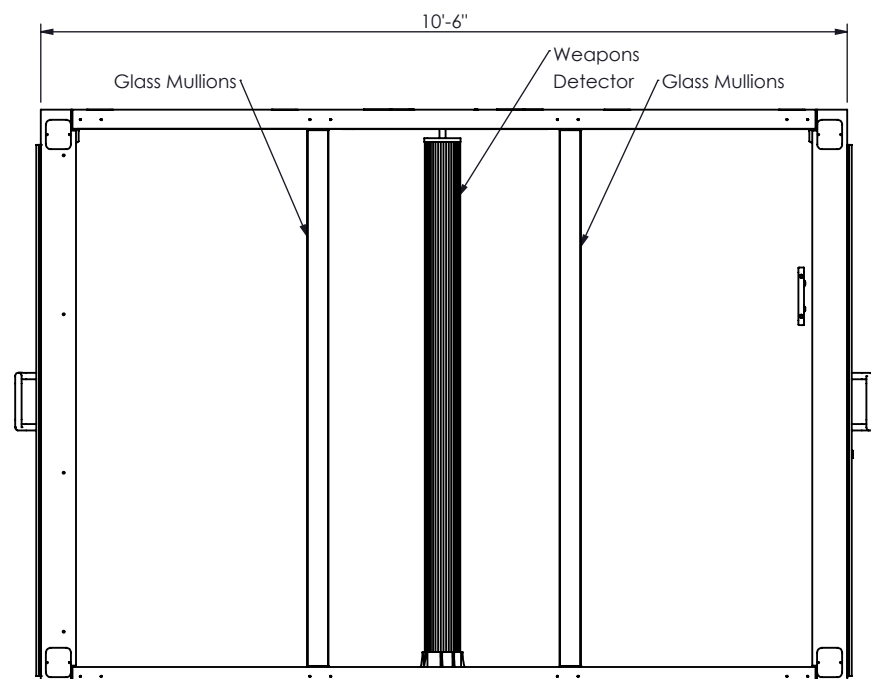

RIGHT SIDE ELEVATION

PAGE	
3	5

est. 1967
HAMILTON
 CUSTOM MADE SECURITY

PROPRIETARY AND CONFIDENTIAL
 THESE DRAWINGS ARE THE PROPERTY
 OF HAMILTON SAFE CO. AND SHALL
 NOT BE REPRODUCED, COPIED, USED
 AS THE BASIS FOR MANUFACTURE OR
 SALE OF APPARATUS WITHOUT
 PERMISSION

IMPORTANT NOTE	
Code Compliance is the Responsibility of the End User Drawing Represents Hamilton's Interpretation Only All Drawing Must Be Approved By Local Municipality	
DESCRIPTION	
Stainless Steel Entrance Control System Significant Changes to ICC A117.1-2017 Accessibility Standard - 2021 Edition Overall Dimensions and Import Notes	
DRAWING/MODEL NUMBER 18-097	DATE 1/24/2022

Floor Inspection

Many commercial building have concrete floors. Concrete floor is recommended to ensure a solid base for the Entrance Control System to attach to for a successful installation. The floor must be stable to avoid ant shocks or movements. Verify the existing slab is level. the maximum allowable deviation is 1/8".

Uneven floors may have to be removed and poured flat and level. The use of self leveling concrete or compound is a good solution to bring the slab within tolerance prior to installation.

Possible Interference

Electrical conduit containing switching power, gas, or water pipes should be relocated.

If an electrical transformer is in close proximity to the weapons detector it could cause interference. Verify the location of the main power box of the facility and make sure the Entrance Control System is not in close proximity

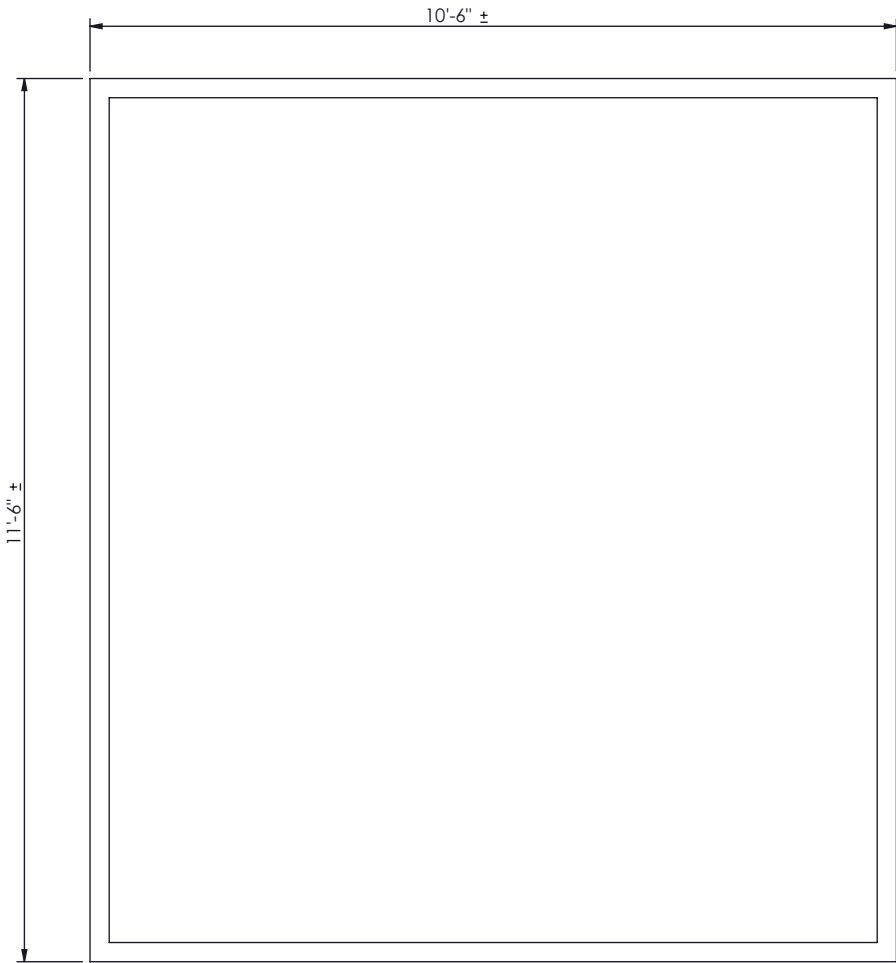

EXISTING SLAB PLAN

Power Requirement:

- Altronix Power Supply is Provided with a NEMA 5-15P Plug
- Electrical Note:
- 110 VAC, 15 Amp Dedicated Unswitched Circuit Outlet

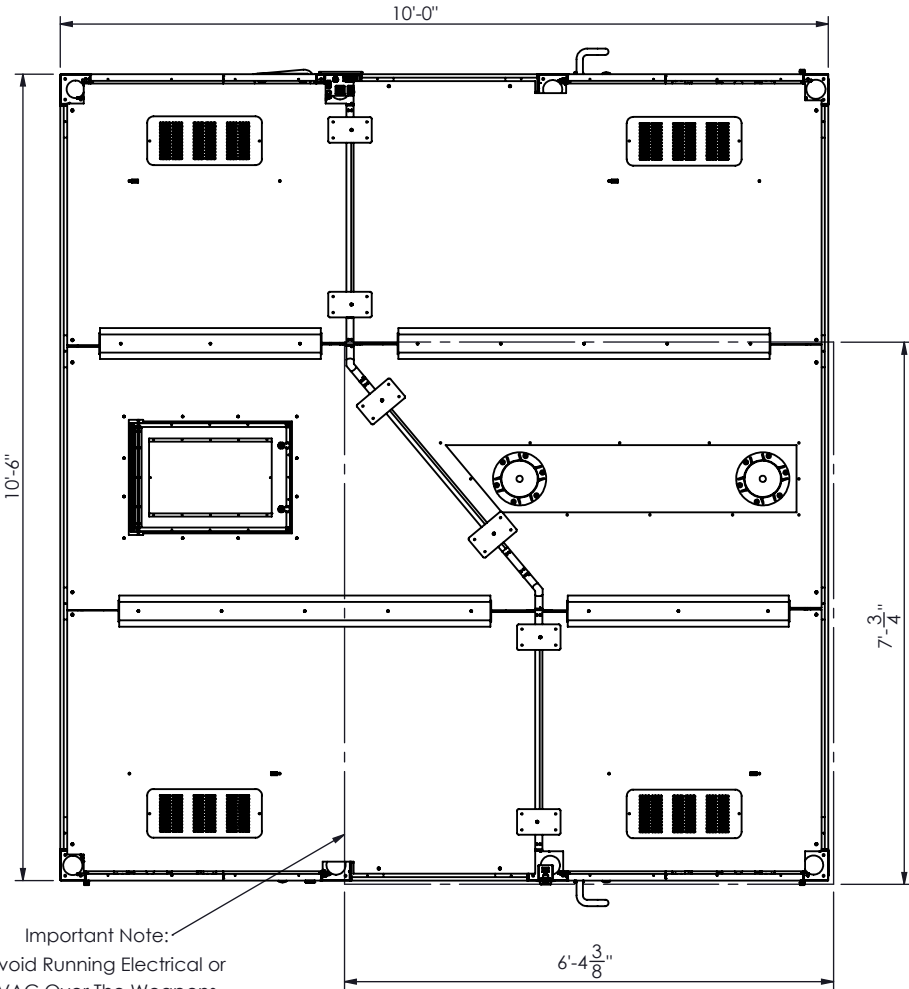

Important Note:
Avoid Running Electrical or HVAC Over The Weapons Detector. The Dotted Line Represents The Area To Avoid.

CEILING PLAN

<div>est. 1967</div> <div>HAMILTON</div> <div>CUSTOM MADE SECURITY</div>	<div>PROPRIETARY AND CONFIDENTIAL</div> <div>THESE DRAWINGS ARE THE PROPERTY OF HAMILTON SAFE CO. AND SHALL NOT BE REPRODUCED, COPIED, USED AS THE BASIS FOR MANUFACTURE OR SALE OF APPARATUS WITHOUT PERMISSION</div>	DESCRIPTION	
		Stainless Steel Entrance Control System Significant Changes to ICC A117.1-2017 Accessibility Standard - 2021 Edition Overall Dimensions and Import Notes	
		DRAWING/MODEL NUMBER	DATE
		18-097	1/24/2022

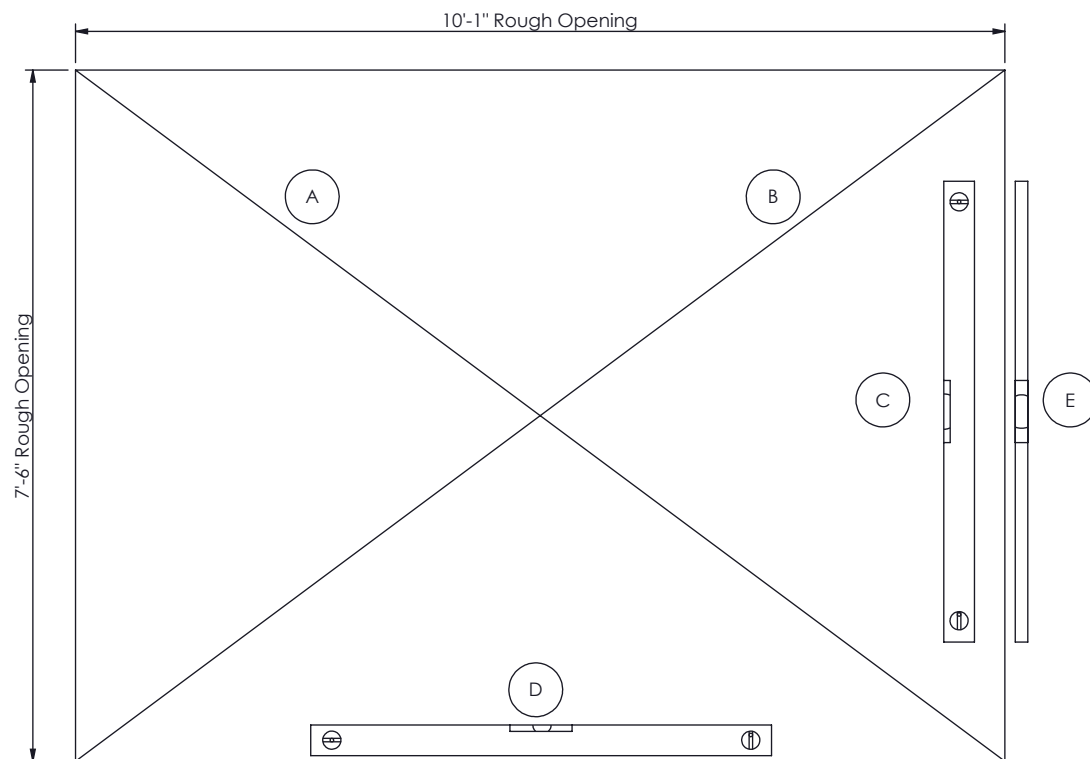

ROUGH OPENING DETAIL

Verify the rough opening is square. The (A) and (B) Measurements should be the same. Maximum allowable deviation from square is 1/8".

Verify the rough opening is plumb and level (C) and (D). The maximum allowable deviation is 1/8".

The rough opening sill must not be crowned or sagged (D).

The exterior face of the rough opening must be in a single plane (E) with less than 1/8" twist from corner to corner.

Minimum double studs should be used at all wood framed rough opening. Metal studs should be avoided and if present they need to be a minimum of 40" from the unit. Steel structural members create Eddy Fields that can cause constant false alarms in the weapons detector system. Normally the fields are created by a small movement in the wall structure from a change in air pressure or door closing creating a vacuum in the entrance control cabin. The system comes standard with vents above each door to prevent this from happening. So do not cover or restrict the air flow above the unit.

The header must be supported by trimmer studs.

IMPORTANT NOTE

Code Compliance is the Responsibility of the End User Drawing Represents Hamilton's Interpretation Only All Drawing Must Be Approved By Local Municipality

DESCRIPTION

Stainless Steel Entrance Control System Significant Changes to ICC A117.1-2017 Accessibility Standard - 2021 Edition Overall Dimensions and Import Notes

DRAWING/MODEL NUMBER
18-097

DATE
1/24/2022

PAGE

5 5

est. 1967

HAMILTON
CUSTOM MADE SECURITY

PROPRIETARY AND CONFIDENTIAL
THESE DRAWINGS ARE THE PROPERTY
OF HAMILTON SAFE CO. AND SHALL
NOT BE REPRODUCED, COPIED, USED
AS THE BASIS FOR MANUFACTURE OR
SALE OF APPARATUS WITHOUT
PERMISSION